

Cabin Safety Support

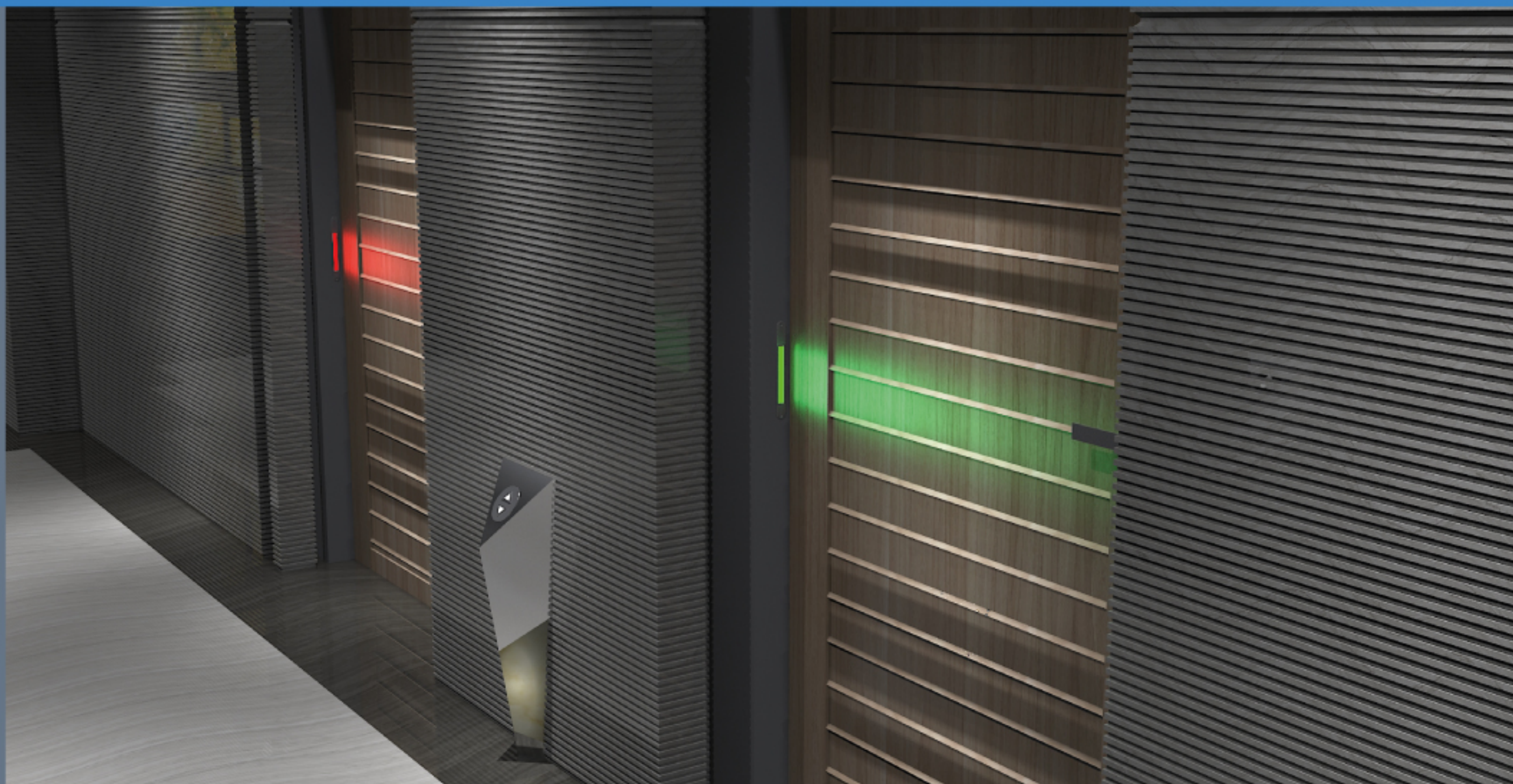

The HI-CSS (Cabin Safety Support) system is a support and signaling system for ship cabins. It can be interfaced with the "Low Location Light" system, allowing for monitoring and reporting of critical alarm situations.

Designed to complement safety systems, HI-CSS allows for the management of light signals as needed, such as backlighting in the event of a power failure or a red light in an emergency.

Developed with the latest technologies, the HI-CSS system guarantees optimal stability and high performance.

The configuration of each individual device is completely customizable based on the customer's needs.

The HI-CSS system can be installed in either a stand-alone or in-line configuration.



CARATTERISTICHE:

- Interfaces with the Low Location Light system.
- Easy installation.
- Customizable signaling.
- High response performance.

Cabin Safety Support

HI-CSS TECHNOLOGY

The HI-CSS device is equipped with RFID technology. Thanks to this, each individual devices can interact with the user in an emergency status, allowing for reporting in extremely critical cases.

This system was designed to manage critical situations such as:

- Illumination of the handle area, both inside and outside the cabin, in the event of a power failure.
- Light signaling of completed cabin inspection.
- Evacuation alert.
- Door opening feedback after inspection.

Designed to monitor entire fire zones, HI-CSS can also be used in "standalone" mode.

Each individual device is equipped with two digital inputs and two digital outputs, allowing HI-CSS to be configured and operate autonomously.

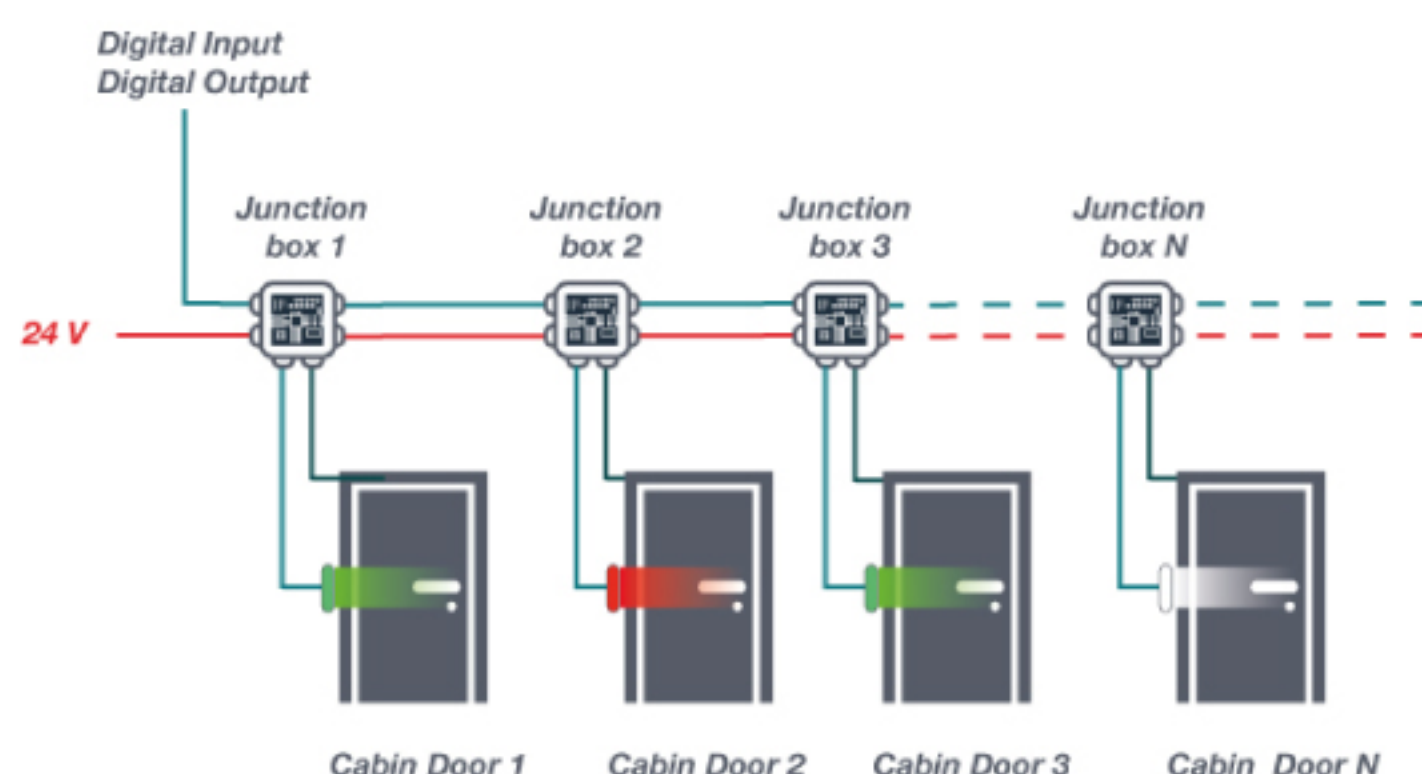
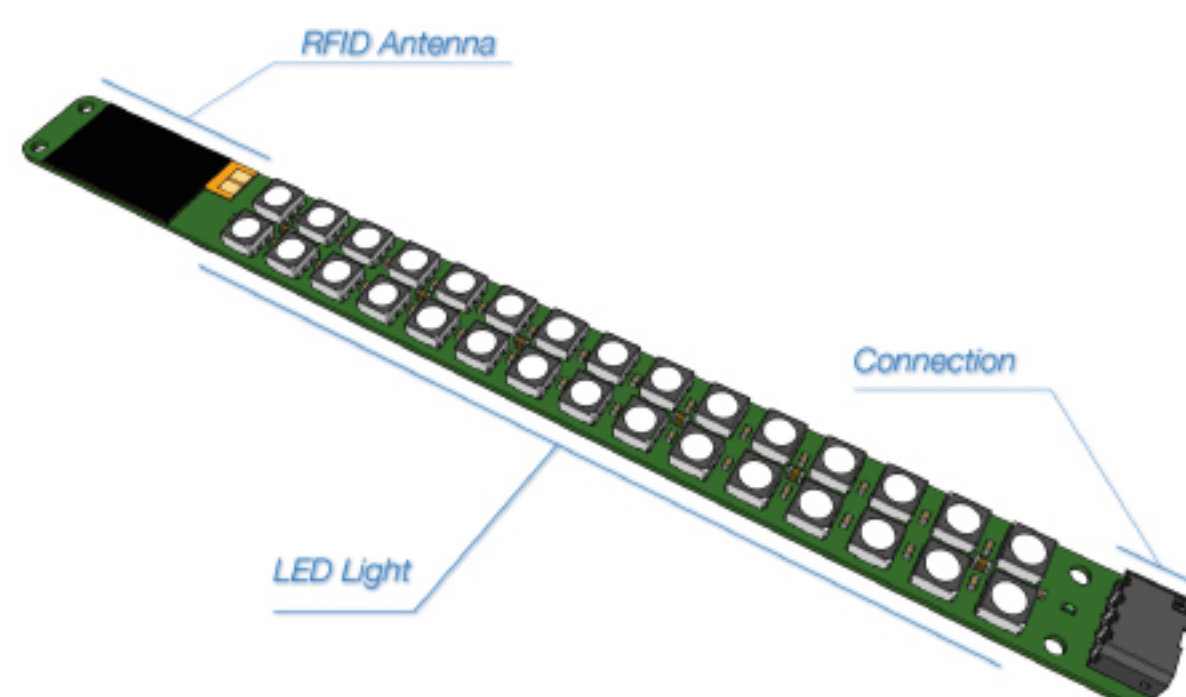

Layout InLine

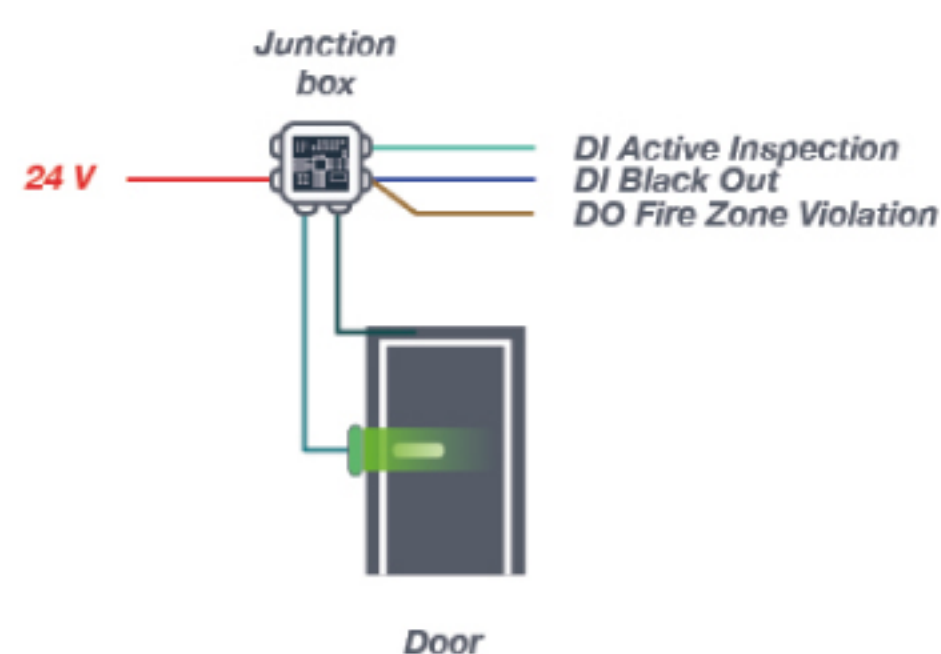

Layout StandAlone

The HI-CSS device also features a 2.8-inch touch screen inside the cabin to activate external devices, with predefined colors to alert onboard personnel to specific actions, such as:

- Do Not Disturb
- Make Up the Room
- Laundry Service



Cabin Safety Support

SYSTEM DESCRIPTION

The HI-CSS system was designed to manage critical situations such as power outages, abandon ship, bomb inspections, etc.

Using an RFID reader combined with a key card, onboard personnel can activate the green light after conducting a cabin inspection.

If the cabin door is opened after the inspection, the HI-CSS system will shut down, signaling a violation of entry into the relevant Fire Zone.

The system consists of a control board for managing the INPUT and OUTPUT, two door cards for the light signal, and a door OPEN/CLOSED switch.

The system is also equipped with a touch screen inside the cabin for service signals such as "DO NOT DISTURB", "CLEANING ROOM," and "LAUNDRY SERVICE."

Regarding the configuration of the INPUT/OUTPUT activation logic, the following is an example.

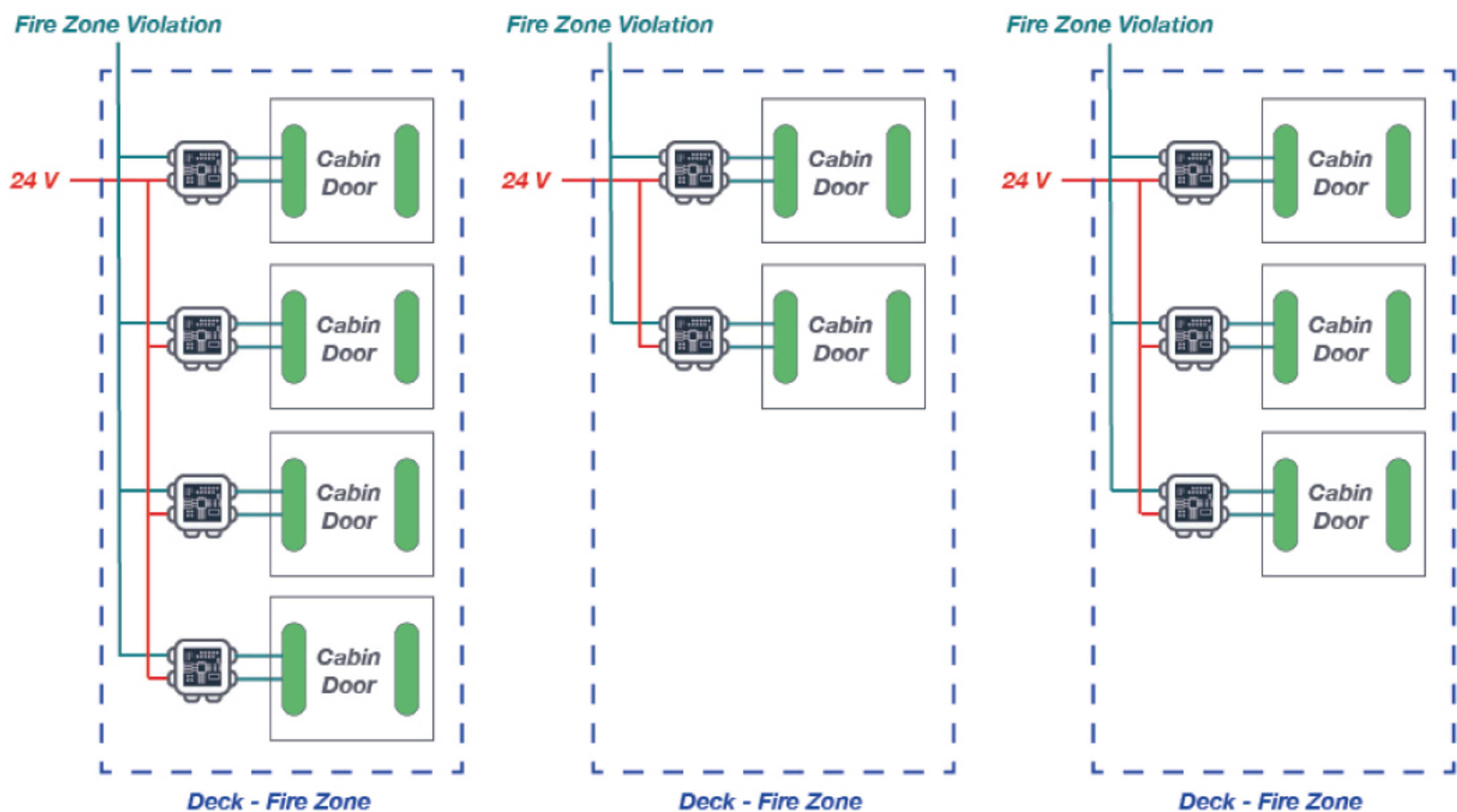

Cabin Safety Support

CONTACT

HI-CSS

Mednarodni prehod, 6
Vrtojba
5290 Šempeter pri Gorici
Slovenia

Administrator Manager

Andrea Ulian

mobile: **+39 347 0081555**

email: **andrea.ulian@hi-css.com**

Sales Department

Roberto Gastaldo

mobile: **+39 347 5110014**

email: **roberto.gastaldo@hi-css.com**

Technical Department

Piero Crasnich

mobile: **+39 347 3201470**

email: **piero.crasnich@hi-css.com**